

Designed for high power applications

### Features

#### ● High voltage tolerance

We offer a variety of different capacitors covering peak test voltages of 25 kVp, 30 kVp, and 35 kVp

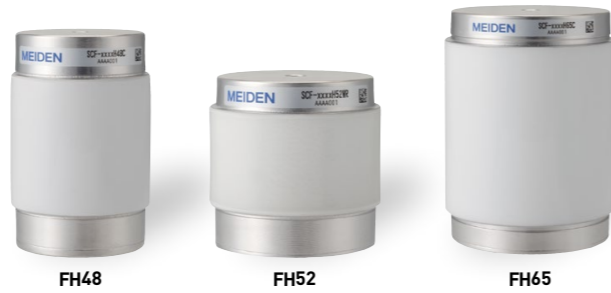

### Low-Loss with High-Purity Alumina Ceramic

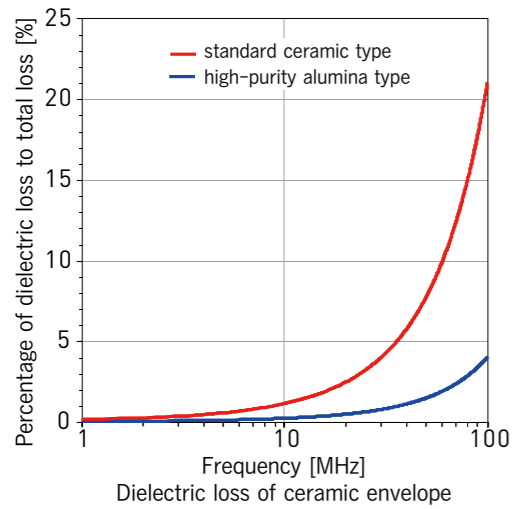

#### Dielectric losses of ceramic envelope

Vacuum capacitor has resistance losses and dielectric as heat losses.

High purity alumina ceramics exhibit reduced low dielectric losses and is recommended for applications requiring higher power at frequencies over 40MHz.



Standard Ceramic Type (FH52)



High Purity Alumina Ceramic Type (FHA52)

### FH Series Product Types

SCF-□□□□□H□□WR

IK-□

Fixed Vacuum Capacitors

- ①: Peak test voltage (kV)
- ②: Capacitance (x100pF)
- ③: Design identification symbol  
 H Alumina Al<sub>2</sub>O<sub>3</sub> 94~98%  
 HA Alumina Al<sub>2</sub>O<sub>3</sub> 98%~ (Apply FH52 only)
- ④: Diameter (mm)
- ⑤: Symbol (Series)  
 C Copper ring electrode  
 WR Copper spiral electrode
- ⑥: Mounting kit (Options)  
 IK-0  
 IK-1

### Optional

#### ● Mounting kit

Screws and washer sets commonly used in installation. Installation kits are sold separately.

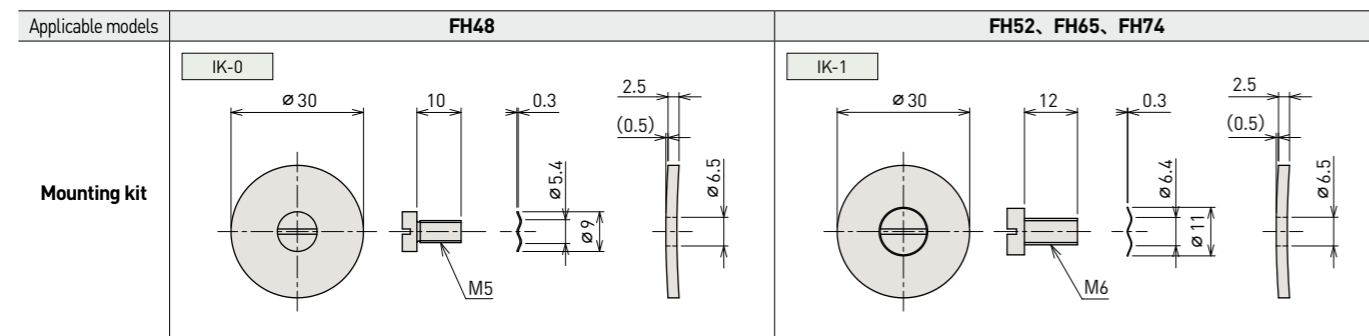

### Type

Type	SCF-300.25H48C	Capacitance (pF) <sup>※3</sup>	Voltage (kVp) <sup>※1</sup>		Current (Arms)			Mounting Dimensions (mm)	Weight (kg)	Options (Mounting kit)
			RF Working	Peak Test	13.56MHz	40MHz	60MHz			
FH48	SCF-300.1H48C <sup>※2</sup>	10	18	30	10	31	47	L 73 × φ48	~0.5	IK-0
	SCF-300.2H48C <sup>※2</sup>	20	18	30	21	63	95			
	SCF-300.25H48C <sup>※2</sup>	25	18	30	27	79	99			
	SCF-300.5H48C <sup>※2</sup>	50	18	30	54	110	99			
	SCF-350.5H48C <sup>※2</sup>	50	21	35	63	110	99			
	SCF-300.75H48C <sup>※2</sup>	75	18	30	81	110	99			
	SCF-350.9H48C <sup>※2</sup>	90	21	35	113	110	99			
	SCF-301H48C <sup>※2</sup>	100	18	30	108	110	99			
	SCF-351H48C <sup>※2</sup>	100	21	35	126	110	99			
	SCF-251.25H48C <sup>※2</sup>	125	15	25	112	110	99			
	SCF-251.5H48C <sup>※2</sup>	150	15	25	135	110	99			
	SCF-301.5H48C <sup>※4</sup>	150	18	30	145	110	99			
	SCF-251.75H48C <sup>※4</sup>	175	15	25	145	110	99			
	SCF-252H48C <sup>※4</sup>	200	15	25	145	110	99			
FHA52	SCF-200.56HA52WR <sup>※2</sup>	56	12	20	40	99	89	L52 × φ 52.4	~0.6	IK-1
	SCF-200.62HA52WR <sup>※2</sup>	62	12	20	44	99	89			
FH52	SCF-151H52WR <sup>※2</sup>	100	9	15	54	99	89	L52 × φ 52.4	~0.6	IK-1
	SCF-201H52WR <sup>※2</sup>	100	12	20	72	99	89			
	SCF-151.5H52WR <sup>※2</sup>	150	9	15	81	99	89			
	SCF-152H52WR <sup>※2</sup>	200	9	15	108	99	89			
	SCF-202H52WR <sup>※4</sup>	200	12	20	130	99	89			
	SCF-152.1H52WR <sup>※2</sup>	210	9	15	113	99	89			
	SCF-152.5H52WR <sup>※4</sup>	250	9	15	130	99	89			
	SCF-153H52WR <sup>※4</sup>	300	9	15	130	99	89			
	SCF-153.5H52WR <sup>※4</sup>	350	9	15	130	99	89			
	SCF-153.75H52WR <sup>※4</sup>	370	9	15	130	99	89			
	SCF-124H52WR <sup>※4</sup>	400	7.2	12	130	99	89			
	SCF-124.5H52WR <sup>※4</sup>	450	7.2	12	130	99	89			
	SCF-125H52WR <sup>※4</sup>	500	7.2	12	130	99	89			
	SCF-155H52WR <sup>※4</sup>	500	9	15	130	99	89			
	SCF-105.5H52WR <sup>※4</sup>	550	6	10	130	99	89			
	SCF-56H52WR <sup>※2</sup>	600	3	5	108	99	89			
	SCF-106H52WR <sup>※4</sup>	600	6	10	130	99	89			
	SCF-126H52WR <sup>※4</sup>	600	7.2	12	130	99	89			
	SCF-106.5H52WR <sup>※4</sup>	650	6	10	130	99	89			
	SCF-107H52WR <sup>※4</sup>	700	6	10	130	99	89			
	SCF-107.5H52WR <sup>※4</sup>	750	6	10	130	99	89			
	SCF-510H52WR <sup>※4</sup>	1000	3	5	130	99	89			
SCF-810H52WR <sup>※4</sup>	1000	4.8	8	130	99	89				
SCF-512.5H52WR <sup>※4</sup>	1250	3	5	130	99	89				
SCF-315H52WR <sup>※4</sup>	1500	1.8	3	130	99	89				
SCF-515H52WR <sup>※4</sup>	1500	3	5	130	99	89				
SCF-317.5H52WR <sup>※4</sup>	1750	1.8	3	130	99	89				
SCF-320H52WR <sup>※4</sup>	2000	1.8	3	130	99	89				
FH65	SCF-350.25H65C <sup>※2</sup>	25	21	35	31	93	118	L 87 × φ 65	~0.8	IK-1
	SCF-350.5H65C <sup>※2</sup>	50	21	35	63	131	118			
	SCF-351H65C <sup>※2</sup>	100	21	35	126	131	118			
	SCF-351.5H65C <sup>※4</sup>	150	21	35	172	131	118			
	SCF-351.75H65C <sup>※4</sup>	175	21	35	172	131	118			
	SCF-352H65C <sup>※4</sup>	200	21	35	172	131	118			
	SCF-352.5H65C <sup>※4</sup>	250	21	35	172	131	118			
	SCF-253H65C <sup>※4</sup>	300	15	25	172	131	118			
	SCF-253.5H65C <sup>※4</sup>	350	15	25	172	131	118			
	SCF-205H74WR <sup>※4</sup>	500	12	20	140	106	96			
	SCF-157.5H74WR <sup>※4</sup>	750	9	15	140	106	96			
	SCF-1010H74WR <sup>※4</sup>	1000	6	10	140	106	96			
	SCF-520H74WR <sup>※4</sup>	2000	3	5	121	92	83			
	SCF-530H74WR <sup>※4</sup>	3000	3	5	121	92	83			
SCF-340H74WR <sup>※4</sup>	4000	1.8	3	121	92	83				

※1: The unit of "Voltage (kVp)" is "0-peak" not "peak-peak".  
 ※2: Max current values assume base sink/convection cooling.  
 ※3: Capacitance tolerance: below 50 pF : ±10%, above 50 pF : ±5%  
 ※4: Water cooling adds 50W thermal capacity.